

# Multi-Unit Charger Housing Pocket Replacement Kit Instruction Manual

## Introduction

The REX4454A Multi-Unit Charger Housing Pocket Replacement Kit is a hardware conversion item. It provides a convenient means of converting existing multi-unit battery chargers from "A" or "B" kits to "C" kits. This replacement kit is approved only for use in converting multi-unit battery chargers as listed in Table 1.

**Table 1: Kit Conversion**

From Kit	Description	To Kit
NTN1177A or B	120 Vac	NTN1177C
NTN1178A or B	International 220 Vac	NTN1178C
NTN1179A or B	International 240 Vac	NTN1179C

## Inspection

When you receive your packaged charger housing pocket replacement kit, inspect the shipping carton for any signs of damage. Next, remove and check the contents of the packing case to be certain that all items have been included. The contents are as follows:

- Pocket sub-assembly (Item 2, Figure 2)
- Label (Item 11, Figure 2)
- This Instruction Manual (68P81086C04)
- Multi-Unit Charger Operating Instructions (68P81083C97).

Inspect the equipment thoroughly. If any part of the equipment has been damaged in transit, report the extent of the damage to the transportation company immediately.

## Tools Required

- 1/4" and 5/16" nut drivers
- awl (used for screw alignment)
- battery
- torque driver

## Charger Disassembly

1. Remove the power cord from the power source and from the back of the charger.
2. Turn the charger upsidedown.
3. Using the 1/4" nut driver, remove the six #8 screws (Item 10, Figure 2) from the perimeter of the bottom plate (Item 9, Figure 2) that secures the outer housing (Item 1, Figure 2).

Note:

**Do not remove or loosen any of the phillips head screws.**

4. Using the 5/16" nut driver, remove the four #10 screws from the center area of the bottom plate that secures the pocket assembly (Item 2, Figure 2).
5. While supporting the bottom plate (Item 9, Figure 2), so it doesn't fall out, return the charger to the upright position, so that pockets face you.
6. Remove the housing (Item 1, Figure 2) and set it aside.
7. Gently lift the old pocket assembly (Item 2, Figure 2), and note the positions of the connectors (see Figure 1). Also, note the orientation of the two metal brackets (under the pocket assembly) that secure the pocket assembly to the baseplate assembly.
8. Gently unplug all connectors (P1, P2, P4, P5, and P6, Figure 1) from the main printed circuit board, and remove the old pocket assembly.



WARNING

**The new housing pocket is for use with batteries listed in applicable operating instructions.**



WARNING

**This kit is intended for the conversion of chargers listed in Table 1 only. Do not attempt to convert other chargers. The electrical properties of the two main printed circuit boards differ.**

## Charger Reassembly

1. With the new pocket assembly oriented as noted in step 7 above (with inside of pockets facing you, and LEDs up), gently plug in all connectors, starting with the center connectors (P1, P6, P5) and followed by the outer connectors (P2 and P4) per Figures 1 and 2.

Note:

**It may be easier to unplug the power supply to main circuit board connector before connecting P1.**

2. Inspect all connections to ensure that they are fully mated, and if disconnected, reconnect the power supply.
3. Turn the new housing pocket in a semi-circular direction to clear all the wires and set it on the charger base (Item 9, Figure 2).



CAUTION

**Ensure that all wires are neatly in place and that the cover does not pinch any wires.**

4. Using the awl, align the holes in the brackets with the holes in the charger base.
5. Using the 5/16" nut driver, start the four #10 screws into the pocket assembly brackets (Item 12, Figure 2).

Note:

**The new pocket assembly brackets are not threaded; the #10 screws will form their own threads. Extra torque may be required to start each screw. Do not tighten at this time.**

6. Replace the outer housing (Item 1, Figure 2).
7. Using the 1/4" nut driver, start the #8 screws (Item 10, Figure 2) that secure the outer housing. If necessary, use the awl to align the holes.
8. Tighten, but do not over-tighten all screws. The four #10 screws should be tightened to 6-8 in-lbs, and the six #8 screws should be tightened to 4-6 in-lbs.
9. Remove the protective adhesive liner from the new label (Item 11, Figure 2), and affix the new label over the existing label on the bottom of the charger.
10. Plug-in the power cord and ensure that all the LEDs light in sequence during the power-up cycle.
11. Ensure that each LED lights for its appropriate pocket by alternately placing a battery in each pocket. If the LED for the pocket adjacent to it doesn't light, a wiring error was made. Disassemble the unit and rewire it per Figure 1.

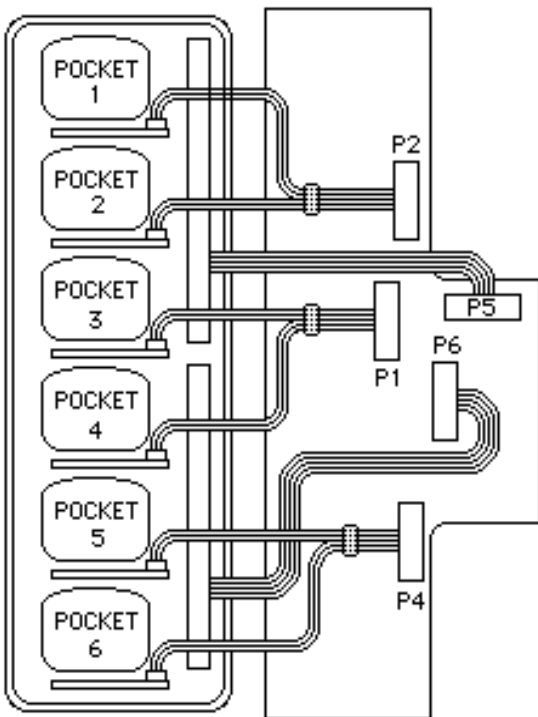

Figure 1. Wiring Diagram

Parts List (Refer to Figure 2.)

ITEM NO.	MOTOROLA PART NO.	DESCRIPTION
1	1505227L02	HOUSING, Multi-Unit Charger
2	REX4454A	ASSEMBLY, Pocket
3	Part of main board	CONNECTOR, 10-position (P5)
4	Part of main board	CONNECTOR, 8-position (P4)
5	Part of main board	CONNECTOR, 8-position (P2)
6	Part of main board	CONNECTOR, 10-position (P6)
7	Part of main board	CONNECTOR, 8-position (P1)
8	--	ASSEMBLY, Main PC Board
9	0105952P82	ASSEMBLY, Baseplate
10	0300131632	SCREW, Tapping, 8-32
11	Part of REX4454A	LABEL, Kit
12	0300129890	SCREW, Lock; #10

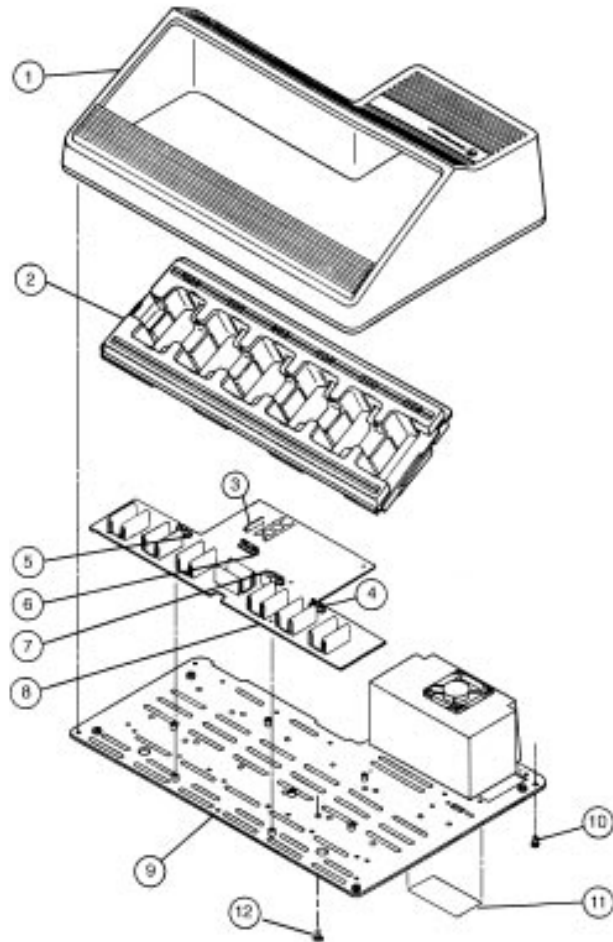

Figure 2. Exploded View

Instruction Manual



68P81086C04-O